

## 260 LIMA® MAC ALTERNATOR



### IN WET OR DUSTY ENVIRONMENTS, THE LIMA MAC ALTERNATOR DELIVERS RELIABLY RUGGED PERFORMANCE AND UNMATCHED MOTOR-STARTING

For decades, the LIMA MAC Alternator has built a reputation for no frills durability. The 260 MAC delivers the same rugged performance as its forerunners, in a leaner unit.

Its heavy duty insulation system, louvered air intake and design simplicity stand up to even the most dust- and moisture-laden applications. It's the ideal partner for an irrigation operation.

- 10, 12, and 15 kW (60 Hz)
- 240V – 480V (60Hz)
- Designed specifically for starting three-phase AC electric motors... again and again
- Delivers 1 hp/kW, Code G induction motor starting capability with 35% voltage dip (80°C rise rating).
- Self-excited and inherently voltage regulated
- With no external voltage regulator or transformers, it provides 4% voltage regulation, virtually maintenance-free
- Inherently provides 500% 3-phase short-circuit support and volts/hertz operation
- Available in one- and two-bearing designs
- Two-year warranty



Base Model 10 Leads 240Y or 480Y 3Ø	3 Phase Continuous NEMA B 80°C R/R	Weight (lbs)
260MSL1054	10	203
260MSL1055	12	251
260MSL1056	15	254

#### Field-proven motor application superiority for:

- Container refrigeration
- Center pivot irrigation systems
- Aggregate processing plants
- Sewage lift stations
- Submersible pump applications
- General-purpose power supply in rental fleets, construction sites and light towers

# 260 LIMA<sup>®</sup> MAC ALTERNATOR

Same unmatched  
motor-starting  
capability

New lighter  
weight design

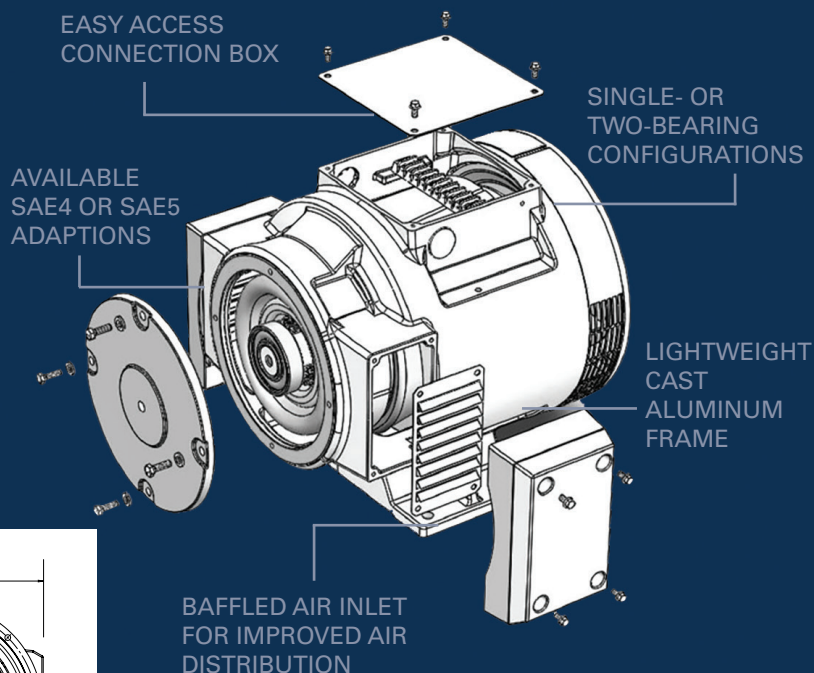
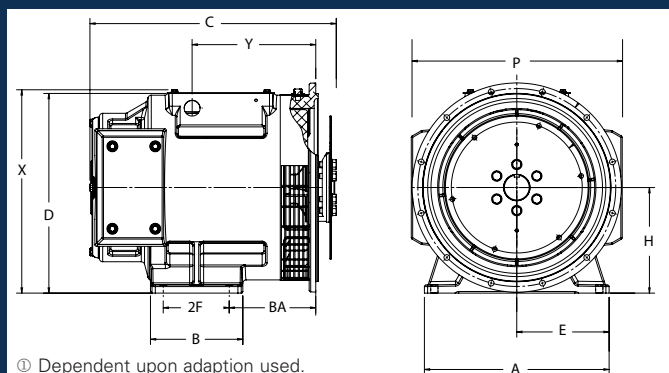

PREVIOUS MODEL	NEW MODEL
280MSL0054	260MSL1056
280MSL0055	260MSL1055
280MSL0056	260MSL1056

Frame Size	A	B	BA①	C①	D	E	2F	H	P	X	Y
260	14.00 (356)	7.00 (178)	6.56 (167)	18.49 (470)	15.14 (384)	7.00 (178)	5.00 (127)	8.00 (203)	15.99 (406)	15.41 (391)	9.37 (238)

**marathon<sup>®</sup>**  
Generators

Reliable power ... *for the long run*

## Regal Rexnord Corporation

100 East Randolph Street  
Wausau, WI 54402-8003  
Phone: 715-675-3359  
Fax: 715-675-8026  
[www.regalrexnord.com](http://www.regalrexnord.com)

### APPLICATION CONSIDERATIONS

The proper selection and application of products and components, including the related area of product safety, is the responsibility of the customer. Operating and performance requirements and potential associated issues will vary appreciably depending upon the use and application of such products and components. The scope of the technical and application information included in this publication is necessarily limited. Unusual operating environments and conditions, lubrication requirements, loading supports, and other factors can materially affect the application and operating results of the products and components and the customer should carefully review its requirements. Any technical advice or review furnished by Regal Beloit America, Inc. and/or its affiliates ("Regal") with respect to the use of products and components is given in good faith and without charge, and Regal assumes no obligation or liability for the advice given, or results obtained, all such advice and review being given and accepted at customer's risk.

For a copy of our Standard Terms and Conditions of Sale, please visit <https://www.regalbeloit.com/Terms-and-Conditions-of-Sale>. These terms and conditions of sale, disclaimers and limitations of liability apply to any person who may buy, acquire or use a Regal product referred to herein, including any person who buys from a licensed distributor of these branded products.

Regal, Lima and Marathon are trademarks and/or tradenames of Regal Rexnord Corporation or one of its affiliated companies.  
©2021 Regal Rexnord Corporation. All Rights Reserved. MCSSP201037E • Form # SB0289E

**RegalRexnord<sup>™</sup>**