

marathon[™]
Generators

MAGNASELECT[™]
Selector Switch Generators



A Regal Brand

REGAL



The MAGNASELECT[™] line features modular design rotary cam switches with solid metal shafts for durable, trouble free service.

Premounted selector switches save assembly time and money.

A Marathon exclusive for enhanced reliability, all switches are mounted in vibration isolated conduit boxes.

Silver plated contacts and the high tension springs inside the switch guarantee solid connections under rough conditions.

Generator output terminals are arranged on the switch for ease of connection to your distribution system. All switches are UL, CE and UL-Canada rated.

For added safety, lockouts are included on all models.

Generators are extensively tested at all voltages in our end of line testing to assure proper performance and connections.

Standard switch location is in left hand side position. Optional right side position is available.

MAGNASELECT[™] generators offer powerful performance, reliable power generation and easy installation. Ruggedly constructed with solid state technology the SE350E voltage regulator, included as standard equipment, provides 1% voltage regulation and offers commercial features such as under speed protection and stability adjustment.

MAGNASELECT[™] designs offer an optional, field adaptable, permanent magnet generator coupled with our PM500 or DVR2000E+ voltage regulators. These configurations provide superior motor starting capability and allow for application in the most demanding installations including loads that produce harmonic distortion as well as those requiring fault current support.

Constructed for extended life by utilizing Marathon's exclusive unirotor construction, UL1446 Recognized Class H insulation system, and long life bearings. MAGNASELECT[™] designs are the ideal general purpose generators for your prime power markets as well as your emergency power needs.



Vibration Isolated conduit boxes, gasketed for environmental protection.

MAGNASELECT™

For All Your Mobile
Power Generation Needs

60
Hertz

**4-Pole
Three Phase**

**1800 RPM
NEMA Class H Insulation
40°C Ambient
0.8 Power Factor Lagging**

Model ①④	Net Wt. (lbs.)	Maximum Amps ②	Continuous Duty kW Rating @ Designated NEMA Rise								
			480 V – 3 Phase High WYE			240/208 V – 3 Phase ③ Low WYE			240 V – Single Phase – 1.0 PF Low ZIG ZAG		
			NEMA B 80°C R/R	NEMA F 105°C R/R	NEMA H 125°C R/R	NEMA B 80°C R/R	NEMA F 105°C R/R	NEMA H 125°C R/R	NEMA B 80°C R/R	NEMA F 105°C R/R	NEMA H 125°C R/R
282PSV28030	295	72	17	20	21	17	20	21	14	16	17.5
283PSV28031	366	104	25	30	33	24	28	30	19	22	25
284PSV28032	436	138	32	36	40	32	36	40	25	30	32
285PSV28033	480	156	38	43	45	36	40	45	30	35	37
361PSV36030	518	145	40	45	48	35	40	42	31	36	38
361PSV36031	569	190	49	55	60	45	50	55	38	42	45
361PSV36032	620	225	58	65	70	53	60	65	45	51	55
362PSV36033	706	277	75	84	90	65	72	80	53	61	66
362PSV36034	796	346	80	96	105	80	90	100	66	76	78
363PSV36035	943	433	110	125	135	100	110	125	80	90	95
431PSV6550	1220	510	125	142	151	125	140	147	96	115	120
431PSV6551	1310	607	143	170	180	142	165	175	106	125	133
431PSV6552	1415	700	165	200	211	170	191	202	131	150	165
431PSV6553	1455	749	180	211	226	176	203	216	131	150	165
432PSV6554	1685	954	220	260	275	220	260	275	156	185	200
432PSV6555	1760	957	230	275	300	225	260	276	156	185	200
433PSV6556	2235	1269	280	342	375	290	343	366	190	220	240
433PSV6557	2245	1335	310	375	403	315	362	385	N/A	N/A	N/A

① Bolt-on PMG option available on all MAGNASELECT™ models.

② Maximum amperage determined using a parallel low WYE connection operation at 208V, 3Ph.

③ Regulator adjustment required for 208V operation.

④ All MAGNASELECT™ models rated 40 kW or higher are UL listed. Models rated lower than 40 kW are UL recognized.

Dimensions in inches and (millimeters)

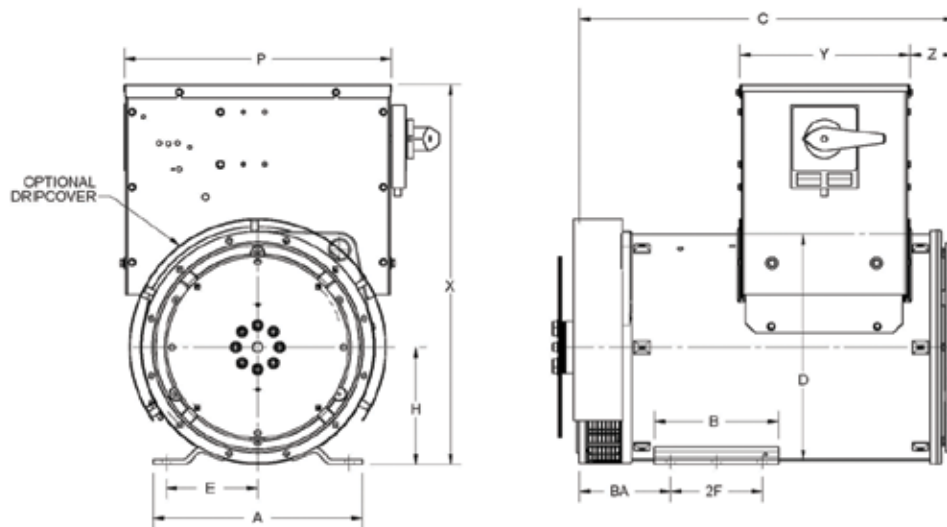

Frame Size	A	B	BA	C	C with PMG	D	E	2F	H	P	X	Y	Z
282	14.00 (356)	7.00 (178)	6.56 (167)	18.50 (470)	23.10 (587)	13.64 (346)	6.25 (159)	5.00 (127)	8.00 (203)	14.98 (380)	26.24 (666)	8.97 (228)	3.37 (86)
283	14.00 (356)	7.00 (178)	6.56 (167)	20.50 (521)	25.10 (638)	13.64 (346)	6.25 (159)	5.00 (127)	8.00 (203)	14.98 (380)	26.24 (666)	8.97 (228)	3.37 (86)
284	14.00 (356)	7.00 (178)	6.56 (167)	22.75 (578)	27.40 (696)	13.64 (346)	6.25 (159)	5.00 (127)	8.00 (203)	14.98 (380)	26.24 (666)	8.97 (228)	3.37 (86)
285	14.00 (356)	7.00 (178)	11.56 (294)	25.00 (635)	29.60 (752)	13.64 (346)	6.25 (159)	5.00 (127)	8.00 (203)	14.98 (380)	26.24 (666)	8.97 (228)	3.37 (86)
361	16.00 (406)	9.50 (241)	7.00 (178)	24.96 (634)	30.06 (764)	17.35 (441)	7.00 (178)	7.00 (178)	9.00 (229)	20.42 (519)	24.92 (633)	13.01 (330)	3.49 (89)
362	16.00 (406)	9.50 (241)	7.00 (178)	28.59 (726)	33.69 (856)	17.35 (441)	7.00 (178)	7.00 (178)	9.00 (229)	20.42 (519)	24.92 (633)	13.01 (330)	3.49 (89)
363	16.00 (406)	9.50 (241)	10.50 (267)	31.72 (806)	36.81 (935)	17.35 (441)	7.00 (178)	7.00 (178)	9.00 (229)	20.42 (519)	24.92 (633)	13.01 (330)	3.49 (89)
431	21.46 (545)	15.00 (381)	10.00 (254)	33.89 (861)	38.27 (972)	22.64 (575)	9.00 (229)	11.00 (279)	13.00 (330)	30.10 (765)	36.08 (916)	16.81 (427)	2.20 (56)
432	21.46 (545)	15.00 (381)	10.00 (254)	37.39 (950)	41.77 (1061)	22.64 (575)	9.00 (229)	11.00 (279)	13.00 (330)	30.10 (765)	36.08 (916)	16.81 (427)	2.20 (56)
433	21.46 (545)	15.00 (381)	10.00 (254)	42.39 (1077)	46.77 (1188)	22.64 (575)	9.00 (229)	11.00 (279)	13.00 (330)	30.10 (765)	36.08 (916)	16.81 (427)	2.20 (56)

All dimensions are approximate.
Refer to outline drawing for full dimensional data.



100 East Randolph Street
Wausau, WI 54402-8003
PH: 715-675-3359
FAX: 715-675-8026

www.marathonelectric.com

A Regal Brand



www.regalbeloit.com